

Soils Map

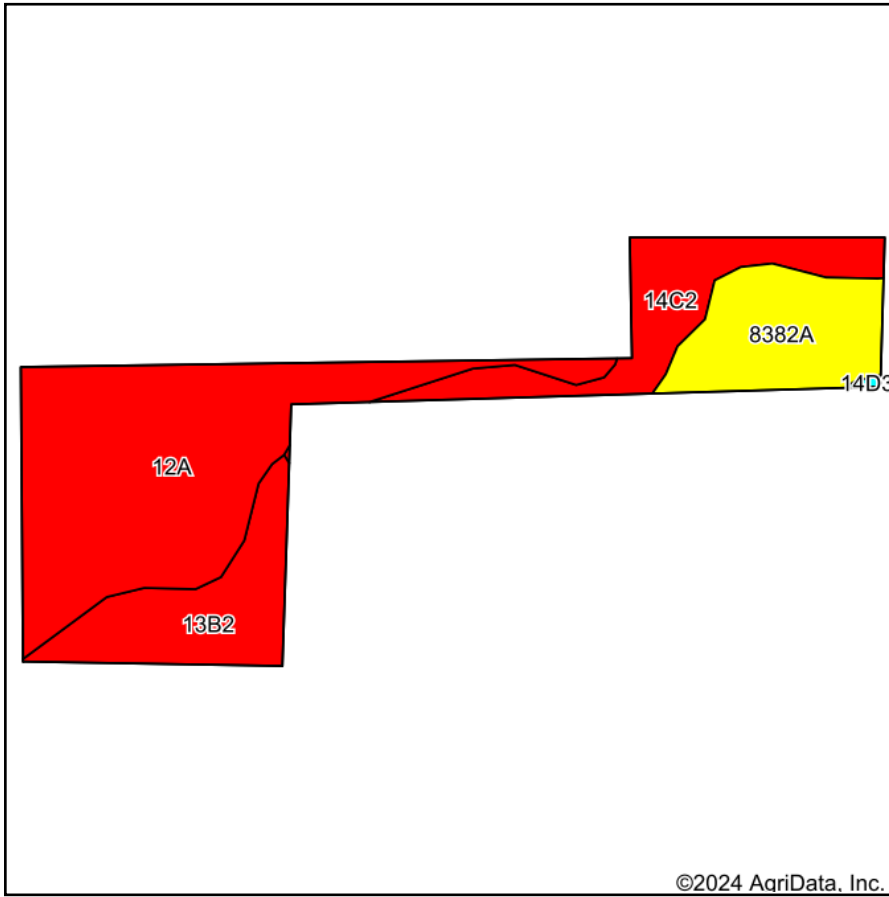

Soils data provided by USDA and NRCS.

©2024 AgriData, Inc.

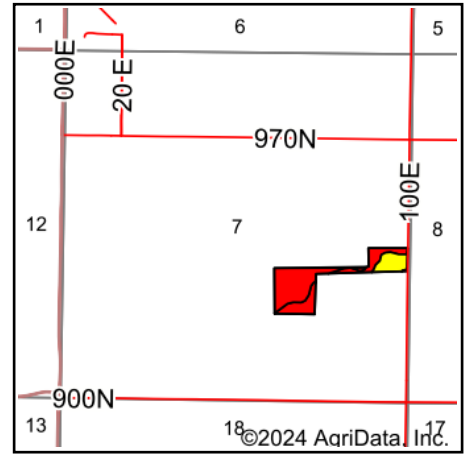

State: **Illinois**
 County: **Lawrence**
 Location: **7-3N-13W**
 Township: **Christy**
 Acres: **16.99**
 Date: **8/27/2024**



Maps Provided By:



© AgriData, Inc. 2023

www.AgriDataInc.com



Area Symbol: IL101, Soil Area Version: 17

Code	Soil Description	Acres	Percent of field	Il. State Productivity Index Legend	Subsoil rooting ^a	Corn Bu/A	Soybeans Bu/A	Wheat Bu/A	Oats Bu/A ^b	Sorghum ^c Bu/A	Grass-le gume ^e hay, T/A	Crop productivity index for optimum management	*n NCCPI Overall	*n NCCPI Corn	*n NCCPI Small Grains
12A	Wynoose silt loam, 0 to 2 percent slopes	8.51	50.1%		FAV	128	42	51	0	108	4.30	97	68	51	68
8382A	Belknap silt loam, 0 to 2 percent slopes, occasionally flooded	2.89	17.0%		FAV	156	52	63	75	0	4.90	117	80	79	65
**13B2	Bluford silt loam, 2 to 5 percent slopes, eroded	2.80	16.5%		FAV	**129	**42	**52	0	**105	**3.20	**96	51	48	51
**14C2	Ava silt loam, 5 to 10 percent slopes, eroded	2.79	16.4%		UNF	**120	**39	**49	0	**95	**2.90	**89	54	54	52
Weighted Average						131.6	43.2	52.9	12.8	87	4	98.9	*n 64.9	*n 55.8	*n 62.1

Soils data provided by USDA and NRCS. Soils data provided by University of Illinois at Champaign-Urbana.

Table: Optimum Crop Productivity Ratings for Illinois Soil EFOTG are sourced from Bulletin 811 calculated Map Unit Base Yield Indices, and adjusted (Adj) for slope, erosion, flooding, and surface texture. Publication Date: 02-08-2023

Crop yields and productivity (B811 EFOTG) are maintained at the following USDA web site: 2023 Illinois Soil Productivity and Yield Indices:

<https://efotg.sc.egov.usda.gov/#/state/IL/documents/section=2&folder=52809>

** Base indexes from Bulletin 811 adjusted for slope, erosion, flooding, and surface texture according to the II. Soils EFOTG

b Soils in the southern region were not rated for oats and are shown with a zero "0".

c Soils in the northern region or in both regions were not rated for grain sorghum and are shown with a zero "0".

e Soils in the well drained group were not rated for grass-legume and are shown with a zero "0".

*n: The aggregation method is "Weighted Average using all components"